

# Ultra Slim Multi Purpose Power Amplifier **Powerstick**



The Powerstick is an ultra slim, light-weight 2 x 500 W power amplifier with integrated DSP controller. It is designed to be integrated into the L-Series Monopod, and can also be mounted directly onto the rear side of an L-Series loudspeaker. Due to the compact form of the Powerstick, it can also easily be integrated into truss constructions or exhibition stands.

## PRODUCT SPECIFICATIONS

<b>Description</b>	Ultra Slim Multi Purpose Power Amplifier
<b>Amp Power</b>	2 x 500 W AES @ 4 Ω / 110-230 V
<b>Rated Current</b>	0,75 A @ 230 V
<b>Min. Load Impedance</b>	2 x 4 Ω
<b>Max. Input Signal</b>	25 dBu
<b>DSP</b>	HDLM FPGA Processing 32 bit floating point
<b>AD / DA</b>	24 bit / 96 kHz
<b>Latency</b>	0,8 ms (analog in to analog out)
<b>Signal/Noise Ratio</b>	115 dB
<b>Connectors</b>	Neutrik XLR in/out Neutrik PowerCon in/out 3 x Neutrik Speakon NL4MP out
<b>Rigging / Fittings</b>	2 x keyhole for wall mounting 10 x hole
<b>Weight</b>	2,6 kg
<b>Size</b> (height x width x depth)	50,8 x 8,5 x 8,2 cm
<b>Order No.</b>	<b>00750/dp</b>



**Powerstick +  
Monopod,  
Design L 16j**

**The Powerstick features integrated digital amplifier electronics with a DSP controller. Various factory-configured presets and volume settings can be selected. The user can program custom presets with the LPI (Loudspeaker Programming Interface).**

High-grade electronic components from the industrial sector and a first-class circuit design ensure excellent audio quality with low distortion and effectively minimise static noise. The optimised „intelligent“ limiters protect the speakers from overload without compromising the potential of modern high-powered speakers.

**Speaker out - 1**

For connection of HiMid systems.  
Amplifier channel 1 (Pin 1+/-)

**Speaker out - 2**

For connection of HiMid systems.  
Amplifier channel 2 (Pin 1+/-)

**Level**

Adjustment in 3 dB steps  
(-6 dB to +3 dB).

**Status**

**Mute LED**

Red light when the system is muted or under technically crucial conditions.

**Limit LED**

Yellow light when the limiter is restricting the level.

**Signal LED**

Green light when the input signal exceeds -20 dBu.

**Power LED**

Green light when the system is switched on.

**XLR**

Symmetrical analog input, max. Input +25 dBu.  
Effective filter protection against HF interference and DC Voltages.  
Virtual ground lift.

**Speaker out 1/2**

Connector for a combination of a mid-high system and a subwoofer with an impedance of 4 Ω minimum.  
Out 1 (Pin 1+/-)  
Out 2 (Pin 2+/-)

**AC in**

Power supply  
~110-230 V / 16 A



**Preset Bank No. 1 - L-Series**

**No. 1 2 x L 16 (Fullrange)**

Preset für Fullrangeanwendungen.

**No. 2 2 x L 16 HP (180 Hz)**

Preset for 2 x L 16 with high pass filter at 180 Hz.

**No. 3 L 16 + G Sub 1201 (160 Hz)**

Preset for one L 16 in combination with up to two G Sub 1201 (crossover frequency ca. 160 Hz).

**No. 4 L 16 + G Sub 1501 (140 Hz)**

Preset for one L 16 in combination with up to two G Sub 1501 (crossover frequency ca. 140 Hz).

**Preset Bank No. 2 - default state**

**No. 1 - 2 x HP 50 Hz**

Preset for use with high-mid systems providing a protective high pass at 50 Hz.

**No. 2 - 2 x Low-Boost**

Preset for use with high-mid systems with an additional bass boost.

**No. 3 - Top + Sub (160 Hz)**

Preset with a 160 Hz crossover frequency for use with smaller high-mid systems in combination with a subwoofer (min. impedance 4 Ω)

**No. 4 - Top + Sub (120 Hz)**

Preset with a 120 Hz crossover frequency for use with high-mid systems in combination with a subwoofer (min. impedance 4 Ω)

**Preset Bank No. 3 - i-Series**

**No. 1 2 x i 4 Flat**

Flat-Preset for 2 x i 4.

**No. 2 2 x i 5 Flat**

Flat-Preset for 2 x i 5.

**No. 3 i 4 HP + G Sub 1001 (160 Hz)**

Preset for i4 in combination with up to 2 passive G Sub 1001. Crossover frequency 160 Hz.

**No. 4 i 5 HP + G Sub 1001 (120 Hz)**

Preset for i5 in combination with up to 2 passive G Sub 1001. Crossover frequency 120 Hz.

**Mode - key**

Switches between control modes: Status, Level and Presets.

**Set - key**

Setting of various values and Mute on / off.

## ACCESSORIES Powerstick

### Monopods for L-Serie

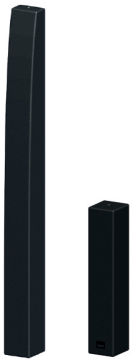

Size and Design like L 16j,  
to be fixed with M20 on bottom  
and M10 on top  
Order No. **00750/L16j**

Size and Design like L 8i,  
to be fixed with M20 on bottom  
and M10 on top  
Order No. **00750/L8i**

### Universal Bag



Universal bag for  
Small Base Plate and accessories,  
with side pocket  
51 cm x 62 cm x 23 cm  
(height x width x depth)

Order No. **01227**

### Tool Set for Monopod



consisting of: wooden plate  
with M20 and M10 screws,  
matching keys, magnetic bits

Order No. **00750/tool**

### Small Base Plate

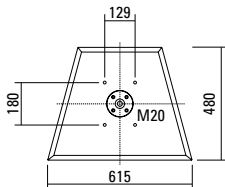

61,5 x 48,0 cm  
with M20 flange

Order No. **01278/M20**

### XL Base Plate

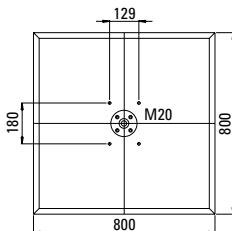

80,0 x 80,0 cm  
with M20 flange

Order No. **01279/M20**

### Hybrid Cable System



PowerCon-PowerCon / XLR-XLR

2,5 m    Order No. **08462**  
5 m     Order No. **08464**  
10 m    Order No. **08466**  
15 m    Order No. **08468**

